



SOUTH ELEMENTARY SCHOOL

8925 NC HWY 86 South
Mebane, NC 27302
(336) 694-1212 – Phone (336) 694-1249 – Fax

Stephen P. Evans, Principal

2021-2022 Arrival & Dismissal Procedures for Bus and Car Riders (Updated 9/23/2021)

Daily Schedule and Entry Locations

The School Day will run from 8:00 am -2:55 pm.

We will have multiple entry points for students.

- Bus Riders will load and unload at the main entrance in front of the school. Parents may not pick up or drop off students in front of the school until after 8:15.
- Upper Grade Students (3-5) will pick up and drop off in the staff parking lot. This entrance is off NC 86. All students will enter the Music Room Door.
- Lower Grade Students (Pre-K - 2nd Grade) will pick up and drop off in the Bus Lot. Traffic will enter and exit out the rear of the lot from NC 119 (See map below). Pre-K and Kindergarten students will enter the building at the covered walkway in front of the cafeteria. 1st and 2nd grade students will enter the door at the Pre-K playground behind the cafeteria

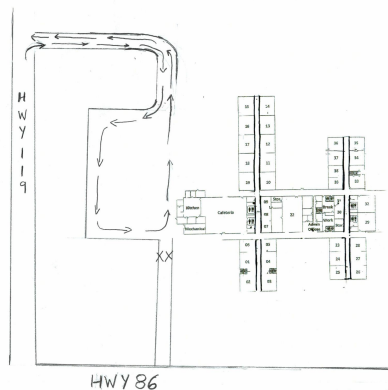

- All students attending school will participate in grab and go breakfast at designated locations each day.

The entry point will also be the exit area in the afternoon: All Traffic entering the bus lot side will enter and exit to and from NC 119.

In the afternoons, we will begin car rider dismissal at 2:45. Bus riders will be dismissed at 2:55.